

# HT1SSH C

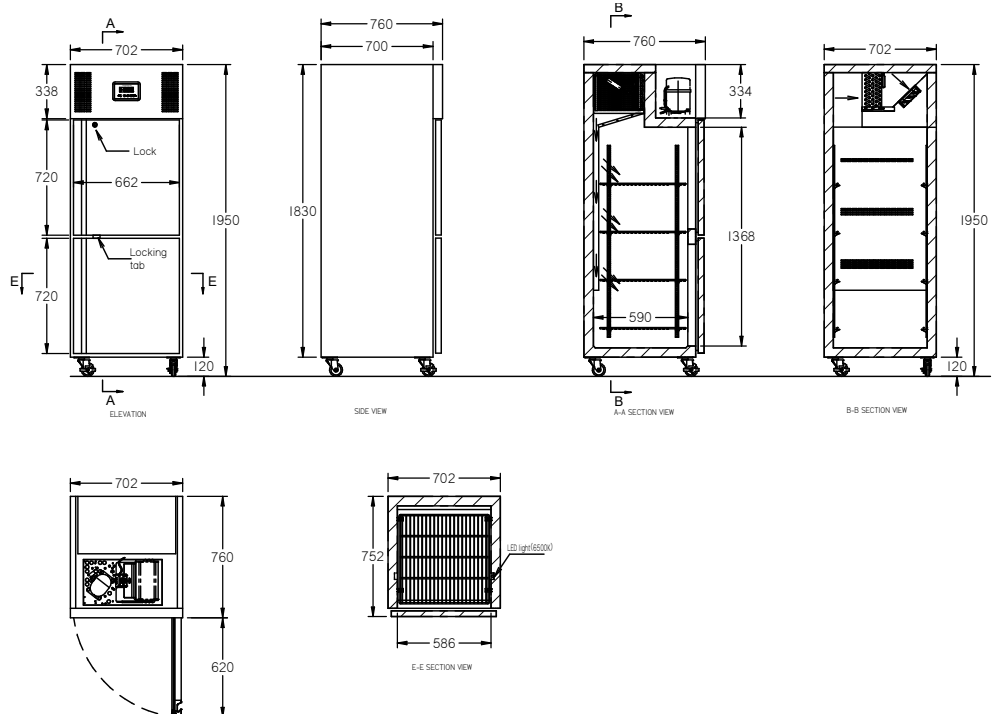

CATEGORY	TOPAZ RANGE
RANGE	<b>Topaz Upright</b>
UNIT	REFRIGERATOR
TYPE	SELF CONTAINED
DOORS/ SPLIT	2



## SPECIFICATIONS

<b>CAPACITY LITRES</b>	408
<b>TEMPERATURE</b>	1°C / 4°C
<b>DIMENSIONS - W X D X H (ON 120 MM H CASTORS) MM</b>	702 W x 760 D x 1950 H
<b>WEIGHT UNPACKED (KG)</b>	100

## STANDARD INCLUSIONS

<b>DOOR TYPE/SPLIT</b>	S (Solid Doors)
<b>FINISH (INTERIOR AND EXTERIOR EXCLUDING REAR AND UNDER)</b>	S (Stainless Steel)
<b>SHELVES (ADJUSTABLE STRIPS AND CLIPS)</b>	4

## GAS TYPE

<b>REFRIGERANT</b>	R290
--------------------	------

## ELECTRICAL

<b>POWER SUPPLY</b>	10 amp
<b>POWER CABLE LENGTH (METRES)</b>	2
<b>RUNNING AMPS</b>	2.1

## PERFORMANCE

<b>KWH/24H READING</b>	2.3
<b>TEMPERATURE CLASS</b>	4 M1
<b>AMBIENT RATING</b>	38°C